



An ISO 9001 : 2015 Certified Company

Committed
to
Quality





About Us

Rigel Flow Tech Pvt.Ltd is leader in flow-control solutions. The company is a technology and engineering conglomerate. RFT has a very good heritage of excellence to design, develop and manufacture valves for key sectors include of General Service to Refineries, Petrochemicals, Oil & Gas Pipeline, Chemical industries and Sugar industries.

As a leading industrial valve manufacturer and supplier, we offer a world-class valves and components for the flow control industry through exceptional service, competitive pricing, and consistent, on-time delivery.

Our product line includes: Gate valves, Check valves, Globe valves, Diaphragm valves, Ball valves and High performance Butterfly valves. Our valves are produced to the highest quality standards with ultra-modern manufacturing technology and astute materials sourcing. We believe in quality and integrity, we work alongside our customers to ensure that every product performs exactly as per the design and requirements and we recognize the need of well suited solutions.

Vision

To be the world leader of valve manufacturing and supply to set standard for product quality, exceptional service, competitive pricing and on-time delivery in the flow control industry. Remain committed, dedicated to our customers and we continuously achieve for excellence.

Mission

We are bound to provide the needs in the valve industry, by manufacturing and supplying valves in all types. We offer standard valves with good quality, to deliver only reliable products to our customers. Rigel flow tech pvt.ltd outstrip client expectations and concern for our valuable customers. We work with dedication and excellence to meet the demands in varies industries.

Quality Policy

Commitment to our customer needs and expectations with an unparalleled breadth of products and connected services, Rigel Flow Tech Pvt.Ltd leads as a global manufacturer supplying and servicing all valves everywhere. The field proven experience enabling customers to achieve top score performance.

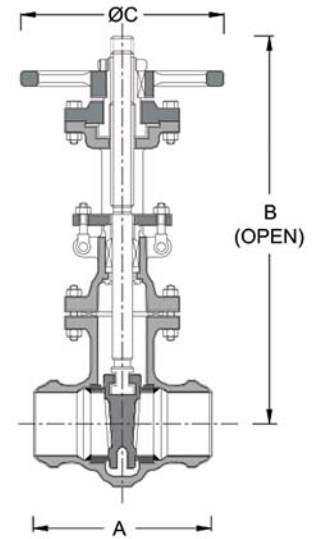
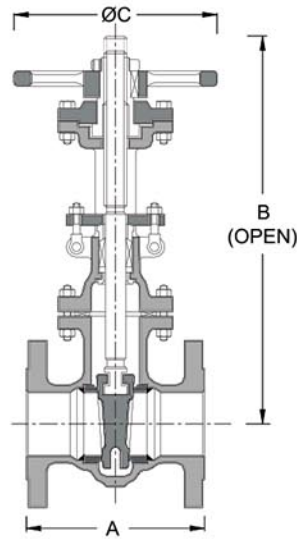

GATE VALVE

CLASS - 150 - 300 - 600

TESTING STANDARD	DESIGN STANDARD	OPERATING DATA	TESTING PRESSURE IN BAR	#150	#300	#600
API 598/ASME B16.34	API 600/API6D/ASME B 16.34	Pressure range up to 104 bar (1480 PSI) Temperature range up to +593° C/1100 F	HYDRO SHELL	30	77	155
			HYDRO SEAT	22	57	113
			AIR SEAT	7	7	7

SIZE mm.	CLASS - 150				CLASS - 300				CLASS - 600			
	A	B	ØC	WT.	A	B	ØC	WT.	A	B	ØC	WT.
15	108	210	100	4.5	140	210	100	5.1	--	--	--	--
20	117	215	100	5.0	152	215	100	6.5	--	--	--	--
25	127	250	150	6.7	165	250	150	8.0	--	--	--	--
40	165	300	200	11.7	190	300	200	14.7	--	--	--	--
50	178	345	200	17	216	345	200	19.6	292	405	250	31
65	190	410	200	26	241	425	250	29	330	420	250	41
80	203	435	250	28	282	460	250	44	356	460	300	53
100	229	550	250	44	305	550	300	76	432	595	450	98
125	254	650	300	56	381	685	450	99	508	690	450	138
150	267	750	300	79	403	790	450	135	559	825	600	216
200	292	960	450	128	419	990	450	218	660	1065	600	361
250	330	1155	450	193	457	1230	600	371	787	1110	750	603
300	356	1390	600	291	502	1475	600	478	838	1770	*	830
350	381	1575	600	318	762	1310	750	583	--	--	--	--
400	406	1710	750	423	838	1870	*	989	--	--	--	--
450	432	1950	750	653	914	2035	*	1191	--	--	--	--
500	457	2225	*	730	991	2220	*	1550	--	--	--	--
600	508	2560	*	1310	1143	2550	*	1812	--	--	--	--

* Bevel Gear Actuators Mandatory

COMPONENTS	MATERIALS
BODY & BONNET	ASTM A216 Gr. WCB, A217 Gr. WC6 / WC9 / C5 / C12, A352 Gr. LCB, A351, Gr. CF8 / CF8M / CF3 / CF3M
WEDGE & SEAT RING	ASTM A217 Gr. Ca15 or WCB + 13% Cr. Facing, WC6, + Stellite, A351 Gr. CF8 / CF8M / CF3 / CF3M
STEM, GLAND & BONNET BUSH	ASTM A276 TYPE 410 / 304 / 316
YOKE SLEEVE	Ni-Resist ASTM A439 Gr.D2 / SGI
GLAND PACKING	Premoulded Grafoil rings / Braided Non asbestos rings / PTFE
GASKET	Spiral Wound 304 / 306 with CAF / Graphite / PTFE filled
STUD / NUT	ASTM A193 Gr. B7/ B16 / B8 / B8M / A194 Gr. 2H / 7 / 8 / 8M
HAND WHEEL	Carbon Steel / Malleable Iron
Surface Protection for Carbon steel Valves	Prime Coat : Chlorine free with modified alkyd resin unobjectionable in physiological and toxicological respects. Additional External Coating : Silver Streak aluminium Paint

* All dimensions are in mm.

* CS/Alloy Steel wedges and Seatings will be over layed with 13% Chrome or Stellite 6 As per customer specifications.

* Optional Features : Jacketed, Bypass arrangement, Locking arrangement, Stem extensions, IBR, Cryogenic & other as per customer requirement.

* Due to continuous developments we reserve the right to change specifications without notice.

* Above 600mm sizes are under development.

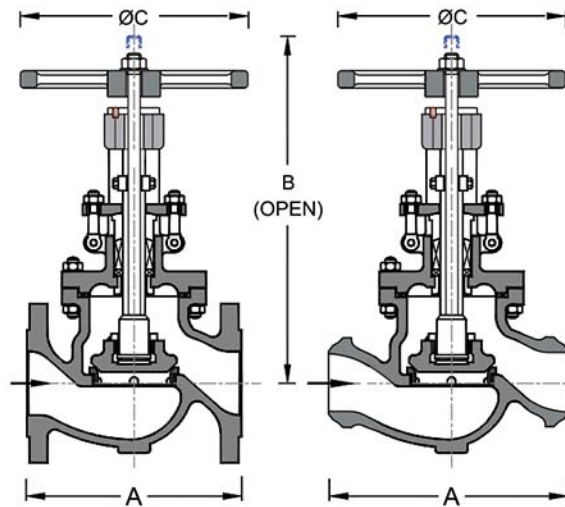

GLOBE VALVE

CLASS - 150 - 300 - 600

TESTING STANDARD	DESIGN STANDARD	OPERATING DATA	TESTING PRESSURE IN BAR	#150	#300	#600
BS EN 12266-1/ASME B16.34	BS 1873/ASME B16.34	Pressure range up to 104 bar (1480 PSI) Temperature range up to +593° C/1100 F	HYDRO SHELL	30	77	155
			HYDRO SEAT	22	57	113
			AIR SEAT	7	7	7

SIZE mm.	CLASS - 150				CLASS - 300				CLASS - 600			
	A	B	ØC	WT.	A	B	ØC	WT.	A	B	ØC	WT.
15	108	205	100	4.6	152	205	100	5.0	--	--	--	--
20	117	210	100	5.1	178	210	100	6.7	--	--	--	--
25	127	230	150	6.6	203	230	150	8.0	--	--	--	--
40	165	260	200	9.7	229	260	200	13.5	--	--	--	--
50	203	295	200	15.1	267	295	200	17.7	292	330	250	41
65	216	290	200	31	292	351	250	36	330	347	300	56
80	241	345	250	37	318	360	300	47	356	408	450	71
100	292	349	300	53	356	413	450	74	432	480	600	122
125	356	410	300	78	400	471	450	111	508	595	*	271
150	406	450	450	93	444	567	600	167	559	1030	*	352
200	495	535	*	166	559	800	*	208	660	1150	*	628
250	622	815	*	245	622	1235	*	453	787	1255	*	853
300	698	900	*	383	711	1435	*	738	838	1330	*	1034

* Bevel Gear Actuators Mandatory

COMPONENTS	MATERIALS
BODY & BONNET	ASTM A216 Gr. WCB, A217 Gr. WC6 / WC9 / C5 / C12, A352 Gr. LCB, A351 Gr. CF8 / CF8M / CF3 / CF3M
DISK & SEAT RING	ASTM A217 Gr. Ca15 or WCB + 13% Cr. Facing, WC6 + Stellite, A351 Gr. CF8 / CF8M / CF8M / CF3 / CF3M
STEM, GLAND & BONNET BUSH	ASTM A276 TYPE 410 / 304 / 316
YOKE SLEEVE	Ni-Resist ASTM-A439 Gr.D2 / SGI
GLAND PACKING	Premoulded Grafoil rings / Braided Non asbestos rings / PTFE
GASKET	Spiral Wound 304 / 316 with CAF / Graphite / PTFE filled
STUD / NUT	ASTMA193Gr. B7 / B16 / B8 / B8M / A194 Gr. 2H / 7 / 8 / 8M
HAND WHEEL	Carbon Steel / Malleable Iron
Surface Protection for Carbon steel Valves	Prime Coat : Chlorine free with modified alkyd resin unobjectionable in physiological and toxicological respects. Additional External Coating : Silver Streak aluminium Paint

- * All dimensions are in mm.
- * CS/Alloy Steel discs and Seatings will be over layed with 13% Chrome or Stellite 6.
- * Optional Features : Additional soft seat, Bypass arrangement, Stem extension, cryogenic, IBR, Locking arrangement & Other as per customer requirement.
- * Due to continuous developments we reserve the right to change specifications without notice.

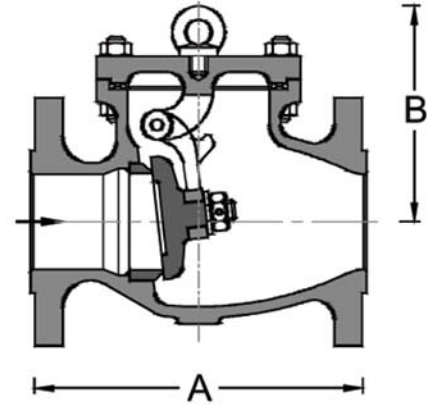

SWING CHECK VALVES

CLASS - 150 - 300 - 600

TESTING STANDARD	DESIGN STANDARD	TESTING PRESSURE IN BAR	#150	#300	#600
API 6D, EN 12266-1 FOR CLASS 150,300 & 600	API 6D, BS 1868 FOR CLASS 150,300,600	HYDRO SHELL	30	77	155
		HYDRO SEAT	22	57	113

SIZE mm.	BOLTED COVER								
	CLASS - 150			CLASS - 300			CLASS - 600		
	A	B	Wt.	A	B	Wt.	A	B	Wt.
40	165	95	7.3	241	95	11	--	--	--
50	203	115	12	267	120	18.5	292	138	25.5
65	216	120	17.5	292	132	21.5	330	145	32.5
80	241	135	25.5	318	150	34.5	356	165	62.5
100	292	150	41.5	356	170	54.6	432	190	116
125	330	170	57	400	210	76	508	220	166
150	356	195	74	444	210	107	559	255	211
200	495	220	104	533	255	161	660	300	356
250	622	260	161	622	305	255	787	335	481
300	698	310	227	711	350	357	838	395	726
350	787	365	353	838	390	623	--	--	--
400	864	505	475	864	530	683	--	--	--
450	978	565	538	978	590	1254	--	--	--
500	978	610	873	1016	655	1464	--	--	--
600	1295	740	1093	1346	790	2059	--	--	--

COMPONENTS	MATERIALS
BODY / COVER / HINGE / BRACKET	ASTM A216 Gr. WCB, A217 Gr. WC6 / WC9 / C5 / C12, A352 Gr. LCB, A351 Gr. CF8 / CF8M / CF3 / CF3M
DISK & SEAT RING	ASTM A216 Gr. WCB, A217 Gr. WCB, A351 Gr. CF8 / CF8M / CF3 / CF3M
GASKET	Spiral Wound 304 / 316 with CAF / Graphite / PTFE filled (Applicable for bolted cover Valves)
STUD / NUT	ASTM A193 Gr. B7 / B16 / B8 / B8M / A194 Gr.2H / 7 / 8 / 8M
Surface Protection for Carbon steel Valves	Prime Coat : Chlorine free with modified alkyd resin unobjectionable in physiological and toxicological respects. Additional External Coating : Silver Streak aluminium Paint

* All dimensions are in mm.
 * CS/Alloy Steel Disc and Seatings will be over layed with 13% Chrome or Stellite 6
 * Optional Features : Jacketed, IBR, Soft Seat & Others as per customer requirement.
 * Due to continuous developments we reserve the right to change specifications without notice.

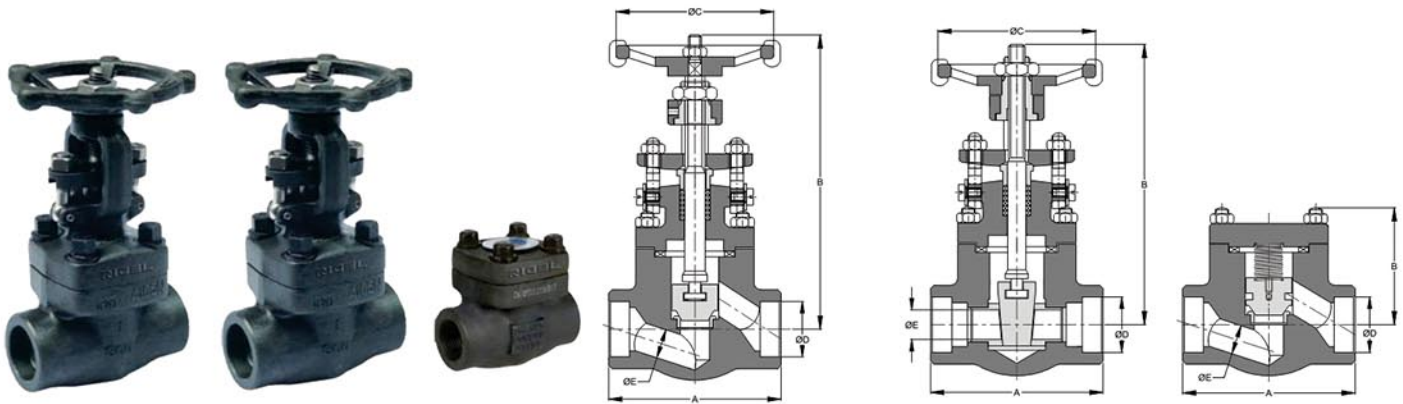

FORGED VALVE

CLASS - 800 - 1500

TESTING STANDARD	DESIGN STANDARD	END CONNECTIONS	TESTING PRESSURE IN BAR	#800	#1500
API 598 / EN 12266-1	API 602, ISO - 15761, BS : 5352, ASME B 16-34	SE Screwed ends to NPT(F) or BSP(F) or BSPT (F) SWE Socket weld ends to ASME B 16.11 BWE Butt weld ends to ASME B 16.25	HYDRO SHELL HYDRO SEAT AIR SEAT	211 152 7	383 281 7

SIZE mm.	FORGED GATE VALVE CLASS - 800						FORGED GATE VALVE CLASS - 1500					
	A	B	ØC	ØD	ØE	Wt.	A	B	ØC	ØD	ØE	Wt.
15	90	158	108	21.8	9	1.7	95	170	108	21.8	9	2.1
20	95	170	108	27.2	12	2.1	105	181	108	27.2	12	3.5
25	105	190	108	33.9	17	3.5	139	247	174	33.9	15	6.6
40	139	258	174	48.8	28	6.6	140	250	174	48.8	27	10
50	160	260	174	61.2	36	10	140	281	174	61.2	34	--

SIZE mm.	FORGED GLOBE VALVE CLASS - 800						FORGED GLOBE VALVE CLASS - 1500					
	A	B	ØC	ØD	ØE	Wt.	A	B	ØC	ØD	ØE	Wt.
15	90	166.5	108	21.8	9	1.7	95	181	108	21.8	8	2.2
20	95	181	108	27.2	12	2.2	105	186	108	27.2	9	3.8
25	105	196	108	33.9	17	3.4	139	248	174	33.9	14	7.8
40	139	266	174	48.8	28	7.8	140	260	174	48.8	25	11.4
50	160	280	174	61.2	36	11.4	140	263	174	61.2	27	--

SIZE mm.	FORGED CHECK VALVE CLASS - 800						FORGED CHECK VALVE CLASS - 1500					
	A	B	ØC	ØD	ØE	Wt.	A	B	ØC	ØD	ØE	Wt.
15	90	55	--	21.8	9	1.46	95	55	--	21.8	8	2
20	95	65	--	27.2	12	2	105	59	--	27.2	9	2.5
25	125	75	--	33.9	17	2.5	139	86	--	33.9	14	6.1
40	149	100	--	48.8	28	6.1	140	86	--	48.8	25	8.9
50	160	105	--	61.2	36	8.9	140	97	--	61.2	27	--

COMPONENTS	MATERIALS
BODY, BONNET, GLAND FLANGE & COVER	ASTM A 105 / ASTM A 182 Gr. F11, F22, F5, F9, F304 & F316
WEDGE / PLUG	ASTM A217 Gr. CA15 / ASTM A 351 Gr. CF8 / CF8M
DISC / SEATING / STEMS & GLAND	ASTM A 276 TYPE 410 / 304 / 316
YOKE SLEEVE	S.G. Iron EN 1563 No. EN-JS 1050 / Nil - Resist ASTM A 439 Gr. D2
PACKING	Pre moulded Grafoil Rings / Braided + Moulded Grafoil Rings
GASKET	Spiral Wound 304 / 316 with CAF / Graphite / PTFE filled
SPRING	ASTM A 312 TYPE 316
STUD / NUT	ASTM A193 Gr. B7 / B16 / B8 / B8M / A194 Gr.2H / 7 / 8 / 8M
HAND WHEEL	Malleable Iron
Surface Protection for Carbon Steel Valves	Prime Coat : Chlorine free with modified alkyd resin unobjectionable in physiological and toxicological respects. Additional External Coating : Silver Streak aluminium Paint

* All dimensions are in mm.
 * Optional Features : IBR, Stem Extension, Position Indicator, Cryogenic, Locking arrangement & Other as per customer requirement.
 * Due to continuous developments we reserve the right to change specifications without notice.

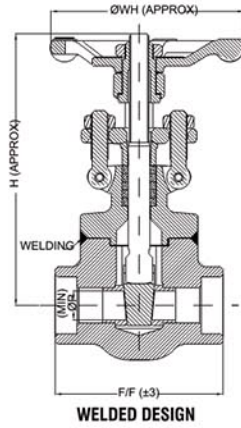

2500#	15mm (1/2")	20mm (3/4")	25mm (1")	32mm (1-1/4")	40mm (1-1/2")	50mm (2")
F/F (mm)	100	120	130	140	140	-
ØP (mm)	7	12.5	15.5	21.5	26.5	-
H OPEN (mm)	187	224	261	318	318	-
H CLOSE (mm)	174	204	239	290	290	-
ØWh (mm)	116	150	150	225	225	-
Approx. Weight (Kg)	2.9	6.1	8.5	14	13.9	-

2500# Straight Type	15mm (1/2")	20mm (3/4")	25mm (1")	32mm (1-1/4")	40mm (1-1/2")	50mm (2")
F/F (mm)	100	145	160	172	172	-
ØP (mm)	7	12.5	15.5	21.5	26.5	-
H OPEN (mm)	178	227	256	303	303	-
H CLOSE (mm)	162	207	224	263	263	-
ØWh (mm)	116	150	150	225	225	-
Approx. Weight (Kg)	3.1	6.5	10	15.1	15	-

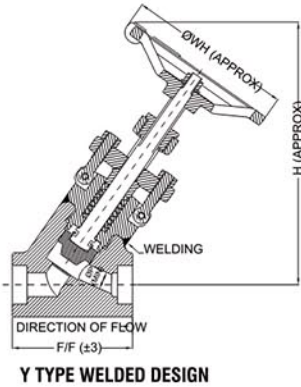
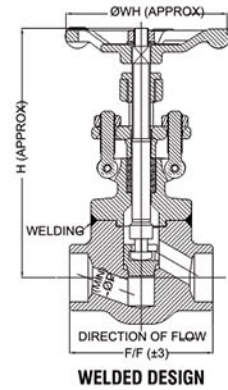

2500# Y Type	15mm (1/2")	20mm (3/4")	25mm (1")	32mm (1-1/4")	40mm (1-1/2")	50mm (2")
F/F (mm)	85	100	105	145	145	145
ØP (mm)	7	12.5	15.5	21.5	26.5	27
H OPEN (mm)	180	222	231	324	324	345
H CLOSE (mm)	175	212	219	309	309	330
ØWh (mm)	116	150	150	225	225	225
Approx. Weight (Kg)	2.5	4	4.6	13.1	13	15

2500# Straight Type	15mm (1/2")	20mm (3/4")	25mm (1")	32mm (1-1/4")	40mm (1-1/2")	50mm (2")
F/F (mm)	100	145	160	172	172	-
ØP (mm)	7	12.5	15.5	21.5	26.5	-
H (mm)	66	86	104	127	127	-
Approx. Weight (Kg)	2	4.6	7.2	10.6	10.6	-

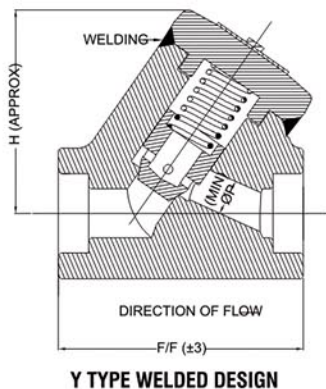
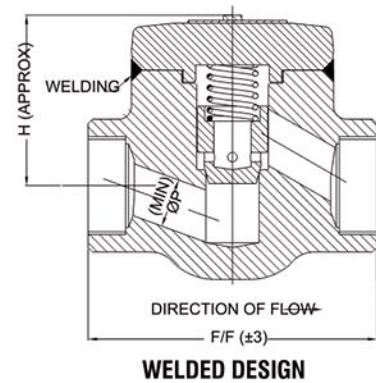

2500# Y Type	15mm (1/2")	20mm (3/4")	25mm (1")	32mm (1-1/4")	40mm (1-1/2")	50mm (2")
F/F (mm)	85	100	105	145	145	145
ØP (mm)	7	12.5	15.5	21.5	26.5	27
H (mm)	72	80	86	118	118	124
Approx. Weight (Kg)	1.3	2.1	2.8	7.1	7	9.5

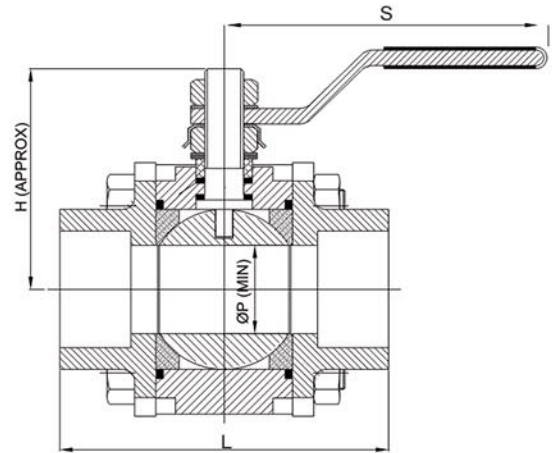

NON FIRE SAFE DESIGN

3PC FLOATING BALL VALVE

CLASS - 150 - 300 - 600 - 800

TESTING STANDARD	DESIGN STANDARD	END CONNECTIONS	TESTING PRESSURE IN BAR	#150	#300	#600	#800
API 598 / EN 12266-1	BS EN ISO 17292/API 6D	Socket weld ends to ASME B 16.11 Screwed ends to NPT(B 1.20.1), BSP,BSPT (BS 21) Butt weld ends to ASME B 16.25	HYDRO SHELL	30	78	153	205
			HYDRO SEAT	22	58	69*	69*
			AIR SEAT	7	7	7	7

SIZE (DN/NPS)	FULL BORE			
	ØP	L	H	S
15 (1/2)	13	67	70	120
20 (3/4)	17	76	76	120
25 (1)	24	86	87	170
40 (1 1/2)	38	116	117	250
50 (2)	49	130	125	250

SIZE (DN/NPS)	REDUCED BORE			
	ØP	L	H	S
15 (1/2)	9	63	68	120
20 (3/4)	13	69	71	120
25 (1)	17	86	85	170
40 (1 1/2)	32	105	115	250
50 (2)	38	120	121	250

COMPONENTS	MATERIALS
BODY, END PIECE, BALL	ASTM A 216Gr. WCB / A351 Gr. CF8, CF8M, CF3, CF3M / A995 Gr. 4A, 5A ASTM A105 / A182 Gr. F304, F316, F304L, F316L, F51, F55
STEM, GLAND	ASTM A 276 Tp. SS410 / SS304 / SS316 / SS304L / SS316L / UNS31803, 32750
SEAT	PTFE, RPTFE, PEEK, DEVLON, NYLON, GFT, CFT
PACKING	PTFE, GFT, GRAFOIL
FASTENERS	ASTM A 193 B7 / B7M / B16 / B8 / B8M, A 320 Gr. L7 / ASTM A 194 2H / 2HM / 8 / 8M / 7
LEVER	CS + Plated + PVC / SS + PVC

TECHNICAL SPECIFICATIONS FOR BALL VALVES	
ANTISTATIC DESIGN	Spring loaded steel balls are provided on stem and ball which gives continuity, thereby reducing the possibility of static electricity that builds during operation when the ball rubs continuously on seat. This can be potential fire hazard.
BLOWOUT DESIGN	Design gives stem entry from inside while doing assembly which gives effective sealing just starting at the stem & at the same time collar prevents blowout of stem due to cavity pressure.
DIRE SAFE DESIGN	In the design secondary metal to metal seat is provided, when the soft seat is burnt out or damaged during the fire. Ball is forced against the metal leap provided and hence forms a metal to metal seat.
LEAKAGE CLASS	No leakage for soft seat (Class VI) / Metal Seat (Class IV)

- * All dimensions are in mm.
- * MOC, Cryogenic & other special requirements can be provided as per customer requirement.
- * Valves will be tested at full pressure as per std for Peek & Metal Seat.
- * Optional Features : IBR, Stem Extension, Position Indicator, Cryogenic, Locking arrangement & Other as per customer requirement.
- * Due to continuous developments we reserve the right to change specifications without notice.

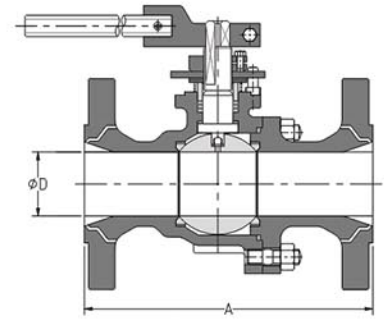
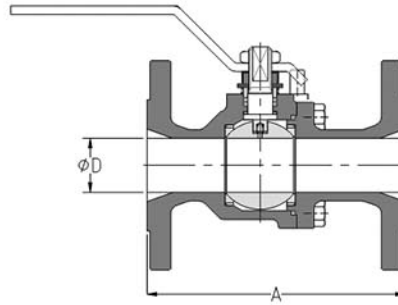

FLOATING BALL VALVE

CLASS - 150 - 300 - 600

TESTING STANDARD	DESIGN STANDARD	TESTING PRESSURE IN BAR	#150	#300	#600
API 6D, API 598, BS EN 12266-1, ISO 5208, ASME B 16.34, API 607 / 6FE	API 6D, API 608, ASME B 16.34, BS EN ISO 17292 (BS 5351)	HYDRO SHELL	30	77	153
		HYDRO SEAT	22	57	113
		AIR SEAT (Soft Seat)	7	7	7

TECHNICAL SPECIFICATIONS	
SEAT LEAKAGE	: NO LEAKAGE (SOFT SEAT) : CLASS IV-METAL SEAT
OPERATIONS	: LEVER / GEAR / PNEUMATIC / ELECTRICAL ACTUATOR
FLOATING BALL VALVE	: 15 NB TO 300 NB FOR CLASS 150, 300, 600 RB/FB / FE / BWE
END CONNECTION	: FLANGE / BUTT WELD ENDS

SIZE mm.	ØD		CLASS - 150			CLASS - 300			CLASS - 600		
	RB	FB	A	Wt.		A	Wt.		A	Wt.	
				RB	FB		RB	FB		RB	FB
15	-	13	108	1.4	1.4	140	2.0	2.7	165	2.8	3.5
20	13	19	117	1.8	2.3	152	2.8	3.7	190	4.5	5.2
25	19	25	127	2.5	3.0	165	4.0	4.7	216	6.2	8.0
32	25	32	140	3.5	4.5	178	5.5	6.5	229	8.5	9.2
40	32	38	165	4.5	6.0	190	8.0	9.5	241	12.5	14.5
50	38	50	178	7.0	8.5	216	10	11	292	15.5	20.5
65	50	62	190	10.5	15.5	241	13	21	330	24	31
80	62	76	203	16.0	18.5	282	25	31	356	32	38
100	76	100	229	23.5	31.5	305	39	49	432	63	88
150	100	152	267	41	57	403	69	140	559	83	-
200	152	201	292	72	93	419	153	223	-	-	-
250	201	252	330	124	155	457	195	278	-	-	-
300	252	303	356	145	288	502	273	-	-	-	-

RB = Reduced Bore, FB = Full Bore FE = Flanged End, BWE = Butt Weld End

COMPONENTS	MATERIALS
BODY / END PIECE	WCB, LCB ASTM A351 Gr. CF8 / CF8M / CF3 / CF3M / CD4MCu / CN7M / DUPLEX
BALL	CA 15 / CF8 / CF8M / CF3 / CF3M / CD4MCu / CN7M / DUPLEX
STEM	Stainless Steel ASTM A 564 TYPE 630 (17-4PH) / ASTM A276 Type 410 Hardened / 17-4 PH
SEAT	PTFE / RPTFE / DELRIN / NYLON / PEEK / METAL
METAL SEAT	Stainless Steel ASTM A276 Type 410 Hardened / ASTM A276 Type 316 Stellite
STEM SEAL	Grafoil / PTFE
STEM WASHER	RPTFE
BODY SEAL	Grafoil / PTFE
GLAND NUT	STAINLESS STEEL
BODY STUD / NUT	ASTM A193 Gr. B7, ASTM A194 Gr. 2H / ASTM A320 Gr. L7, ASTM A194 Gr. 7

- * All dimensions are in mm.
- * Gear operation suggested dimensions on request.
- * Valves upto 150 RB with lever.
- * All sizes of Ball valves can also be provided with gear actuators (Electrical / Pneumatic / Flanged End with Ring Type Joint Facing Available).
- * Due to continuous developments we reserve the right to change specifications without notice.

*** RING JOINT FLANGED OR WELDING ENDS**
*** LEVER OPERATED**

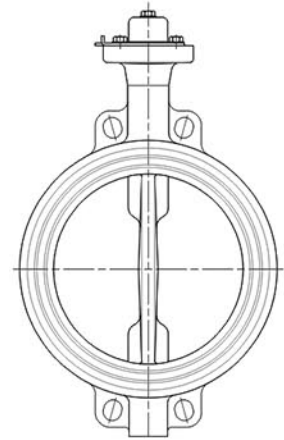
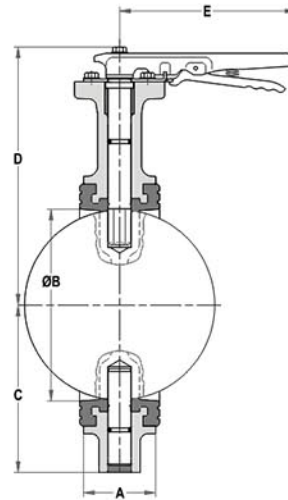

RUBBER - LINED BUTTERFLY VALVE

TESTING STANDARD	DESIGN STANDARD	TEST PRESSURE Kg/cm ²	PN 10	PN 16
API 598 / BS EN 12266-Part 1, 2	API 609/BS EN 593	HYDRO SHELL	15	24
		SEAT	11	18
		AIR SEAT	7	7

SIZE mm	A	ØB	C	D	E	MOUNTING FLANGE DRILLING			Wt. Kg. (Approx.)	TORQUE, Nm. (Approx.)
						HOLES	HOLE Ø	PCD		
50	43	50	65	135	260	4	19.1	120.7	2.5	10
65	46	65	70	155	260	4	19.1	139.7	3.0	13
80	46	76	80	160	260	4	19.1	152.4	4.0	18
100	52	100	95	180	260	8	19.1	190.5	5.5	33
125	56	125	110	210	260	8	22.3	215.9	6.5	54
150	56	150	125	215	260	8	22.3	241.3	7.5	70
200	60	200	160	400	200	8	22.3	298.5	18.0	135
250	68	250	200	465	220	12	25.4	362.0	27.0	200
300	78	300	225	510	250	12	25.4	431.8	36.0	275

COMPONENTS	MATERIALS
BODY	CI (IS:210-FG 220) /WCB (ASTM A216)
DISC	SGI (ASTM A536-60.40.18)/CF8 & CF8M(ASTM A351)
SEAT	EPDM / NITRILE
STEM	410/304/316 - (ASTM A276)
O-RING	NITRILE

* OPTIONAL FEATURES UPON REQUEST

- Wafer-lugged ends.
- Pneumatic / Electrical actuator.
- Other MOC, as per customer requirement.
- Other flange-drillings, subject to confirmation.
- Locking arrangement.
- Stem extension.
- Lever operation up to sizes 150NB; Gear actuators are recommended for sizes 200NB and above.

* All Dimensions are in mm.

* Due to continuous development we reserve the right to change specifications without notice.

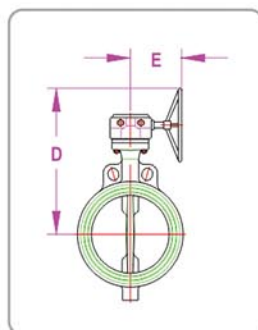

WITH GEAR ACTUATOR
(FOR DN ≥ 200)

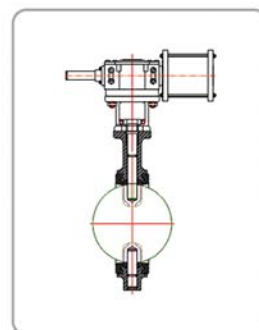

WITH PNEUMATIC ACTUATOR

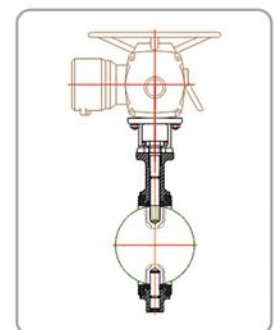

WITH ELECTRICAL ACTUATOR

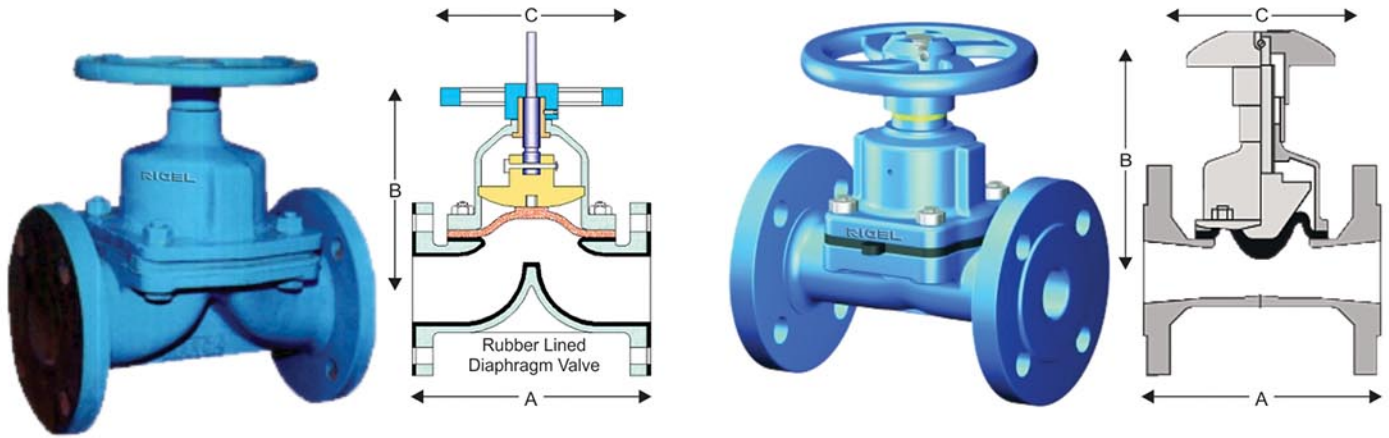

DIAPHRAGM VALVES

DESIGN STANDARD	TESTING STANDARD	TEST PRESSURE IN BAR	WEIR TYPE			STRAIGHT TYPE			
BS EN 13397	BS 6755-1	Pressure rating in bar 2)	16	10	7	5	10	7	5
		HYD. SHELL	24	15	10.5	9	15	10.5	6
		SEAT	16	10	7	6	10	7	5
		AIR SEAT	5			5			

WEIR TYPE											STRAIGHT THROUGH TYPE						
A						B	C	Wt 1)			A		B	C	Wt 1)		
BS				DIN	MSS			BS	DIN	MSS	BS		DIN			BS	DIN
SIZE	unlined	Rubber Lined	PFA Lined	Unlined & Lined	SP-88 PFA Lined						unlined	Lined	Unlined & Lined				
15	108	114	114	130	108	92	70	2.5	2.8	2.5	108	114	130	90	70	2.4	2.6
20	117	123	123	150	149	100	70	2.6	3.2	3.0	117	123	150	90	70	2.8	3.0
25	127	133	133	160	149	114	100	3.5	4.2	4.0	127	133	160	112	100	4.2	4.6
32	146	152	152	180	152	115	100	4.5	5.5	5.0	146	152	180	112	100	4.5	5.5
40	159	165	165	200	176	153	140	7.0	8.0	7.5	159	165	200	112	100	5.5	6.0
50	190	196	196	230	202	160	140	10	15	11	190	196	230	146	140	10	11
65	216	222	222	290	222	180	180	15	19	16	216	222	290	177	180	15	17
80	254	260	260	310	264	233	225	22	26	23	254	260	310	205	225	25	28
100	305	313	313	350	329	256	225	37	42	37	305	313	350	244	225	32	36
125	356	364	362	400	416	306	310	62	68	70	356	364	400	272	310	57	64
150	406	414	412	480	416	368	368	91	106	93	406	414	480	433	368	66	81
200	521	529	527	600	530	479	471	163	185	166	521	529	600	420	368	115	135
250	635	645	--	730	--	585	587	240	275	--	635	645	730	545	587	180	235
300	749	759	--	850	--	689	690	418	480	--	749	759	850	640	587	280	335
350	749	759	--	980	--	830	690	480	550	--							

All Dimensions are in mm

COMPONENTS	MATERIALS
BODY/BONNET / COMPRESSOR	Cast Iron ASTM a 126 Class B / EN-1561 No. EN-JL1040 / S G Iron EN-1503 No. EN0JS 1024, Cast Steel ASTM A 743 Gr. CC50/ASTM A 216 Gr. WCB / Stainless Steel ASTM A 351 Gr. CF8 / CF8M / CN7M
BODY LINING	Ebonite Natural / Butyl / Neoprene / EPDM / Nitrile, other Elastomers & even PFA etc.,
DIAPHRAGM	Natural / Butyl / Neoprene / EPDM / Nitrile, other Elastomers & even PTFE etc.,
STEM	Steel ASTM a 276 TYPE 410
BUSHING	S G Iron EN-1563 No. EN0JS 1050
CONNECTING STUDS / NUTS	Steel Gr 4.6 / 4
HANDWHEEL	Cast Iron ASTM A 126 Class B / EN-1561 No. EN-JL 1040
SURFACE PROTECTION FOR CAST IRON AND CAST CARBON STEEL VALVES	Prime Coat : Chloride free with modified alkyl resin unobjectionable in physiological and toxicological respects. Additional external coating : stoving enamel

1) Nett in Kg. approx. (without obligation) 2) Pressure rating of Weir Type for size 15 to 50 - 16 bar, for Sizes 65 to 150 - 10 bar, for Size 200 - 7 bar, for Sizes 250 to 350 5 bar. Pressure rating of Straight Type for Sizes 15 to 100 - 10 bar, for Size 125 - 7 bar, for Sizes 150 to 300 - 5 bar.

* Face to Face Dimension (A) for Size 350 As per MFRS Standard.

* For Weir Type all Alloy Steel and Corrosion Resistant Steel Bodies, Bonnets & Compressors for Sizes 15 to 100 are in investment casting.

* Valves Flanges can be drilled to suit ASME 7 BS / DIN / JIS

* Please Specify Working Pressure, Temperature & Service conditions.

* Valves can be supplied with Pad-lock, Chainwheel, Travel Stop Arrangement, Extended type Stem, Electrical / Pneumatic Actuators & other accessories like Limit switch, Solenoid Valve, Air filter regulator, Positioner etc.,

* Other Materials not mentioned above available on requests.

INDUSTRIES SERVED

Oil & Gas

Petroleum Refineries

Equipment Mfgr's

Pharmaceuticals

Water treatment

Steel & Allied Industry

Chemical Industry

Sugar Industry

Power Plants

Boiler Mfgr's

Sewage Treatment

Textile Industry

Many more...



RIGEL
FLOW TECH PVT. LTD

 Gokul Road, HUBLI - 580 030.
(Karnataka) INDIA.

 +91 9900652818

 info@rigelft.com | rigelft@gmail.com

 www.rigelft.com